

RELEASED FOR MANUFACTURE
 DATE: 01/06/10 SIGN: [Signature]

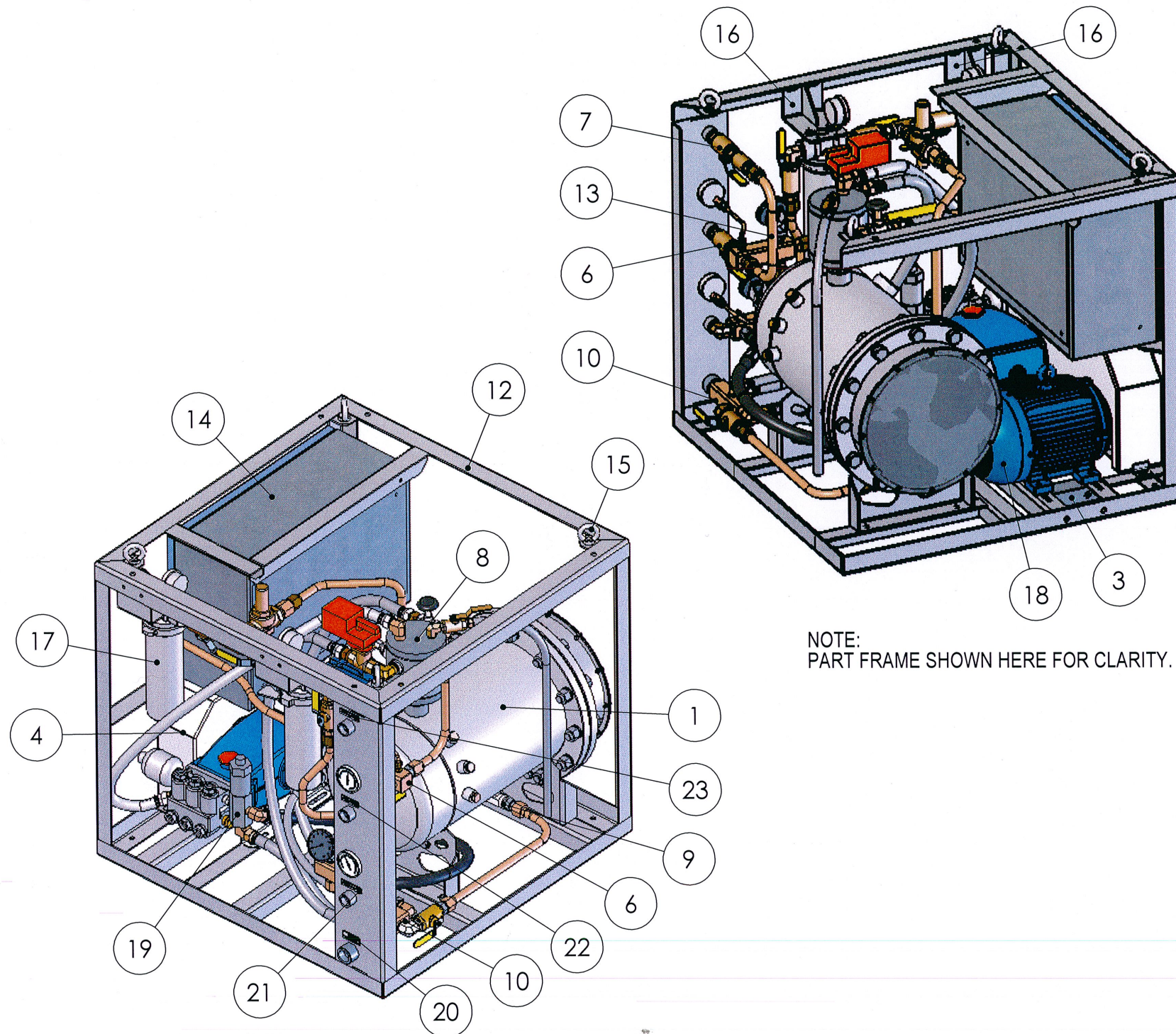

ITEM NO.	PART NUMBER	DESCRIPTION	Bent Up Frame/QTY.
1	05969	Heater Tank Assembly	1
2	06050	PULLEY 118 x 2 SPB,TL 1610/28	1
3	06025	Motor Adjusting Assembly	1
4	05987	Belt Guard Assembly	1
5	05960	Hot Water Supply Manifold Assembly	1
6	05958	Sea Water In Manifold Assembly	1
7	06042	Fresh Water For Rinse Assembly	1
8	06040	Level Switch Pot Assembly	1
9	06038	Tank Bottom Manifold Assembly	1
10	05959	Dump Manifold Assembly	1
11	06037	Tank Relief Assembly	1
12	05729	MHE Frame (Bent) Weld Assembly	1
13	06044	Fresh Water Rinse / Sea Water In Pipe	1
14	05939	Control Panel Assembly	1
15	06007	M12 Female Thread Lifting Eye, 340 Kg. W.L.L.	4
16	06018	FILTER BRACKET ASSEMBLY	2
17	06019	Filter Assembly	1
18	06051	WEG , 4kW - 4 POLE 112M FRAME RH.	1
19	06036	Pump Relief To Dump Assembly	1
20	06070-3	LABLE, DUMP DO NOT BLOCK	1
21	06070-2	Lable, "DIVER HOT WATER"	1
22	06070-1	Lable, "SALT WATER IN"	1
23	06070	Lable, "FRESH WATER IN"	1

R02

THIRD ANGLE PROJECTION 		MATERIAL: SEE BOM		FINISH:		MASS: (kg) 263.44		COPYRIGHT EXISTS IN THIS DRAWING AND ALL INFORMATION THEREIN IN TERMS OF COPYRIGHT LAW. THIS DRAWING IS ONLY TO BE USED FOR THE PURPOSE FOR WHICH IT WAS SUPPLIED TO THE SECOND PARTY AND MAY NOT BE REPRODUCED IN WHOLE OR IN PART BY ANY MEANS WHATSOEVER AND ITS CONTENTS MAY NOT BE DISCLOSED TO ANY OTHER PARTY WITHOUT THE CONSENT OF DIVEX OCEANICS (PTY) LTD. NO LICENCE OR RIGHTS TO MANUFACTURE THE EQUIPMENT IS GIVEN OR IMPLIED.		 DIVEX (PTY) LTD 11 DAWN ROAD MONTAGUE GARDENS CAPE TOWN, 7441 SOUTH AFRICA. TEL : +27 (0)21 551-2233 FAX : +27 (0)21 551-2275 email : info@divexglobal.com www.divexglobal.com		A3					
REV	DESCRIPTION OF REVISION	ECN	DRAWN	DATE	DRAFTING CHECK BY	DATE	ENGINEER CHECK BY	DATE	APPROVAL BY	DATE	OVER-TO	±	±	±	SCALE	PRODUCT/PROJECT	TITLE
R02	CHANGED MOTOR TO 4 POLE	CT00276	R.H.	27/05/10	R.C.	27/05/10	N.M.	27/05/10	N.M.	27/05/10	0-6	0.1	0.2	0.5	1:10	MHE-02	MHE-02 (Mini Heater Electric) General Assembly
R01	AS BUILT		R.H.	15/10/09	R.C.	17/10/09	N.M.	17/10/09	N.M.	17/10/09	6-30	0.2	0.5	1.0	ALL DIMENSIONS IN MM (UOS) DO NOT SCALE	PART No. 06008	REV R02
R00	FIRST ISSUE	---	R.H.	03/08/09	R.C.	27/08/09	N.M.	27/08/09	N.M.	27/08/09	30-100	0.3	0.8	1.5			
											100-300	0.5	1.2	2.0	ALL DIMENSIONS BEFORE PLATING (UOS)	CAD REF/DRG No. 06008	SHT 1 OF 3
											300-1000	0.8	2.0	3.0	REMOVE SHARP EDGES & BURRS		
											1000-3000	1.2	3.0	5.0			
											3000-PLUS	2.0	4.0	8.0			
											ANGLE	0.25°	0.5°	1°			

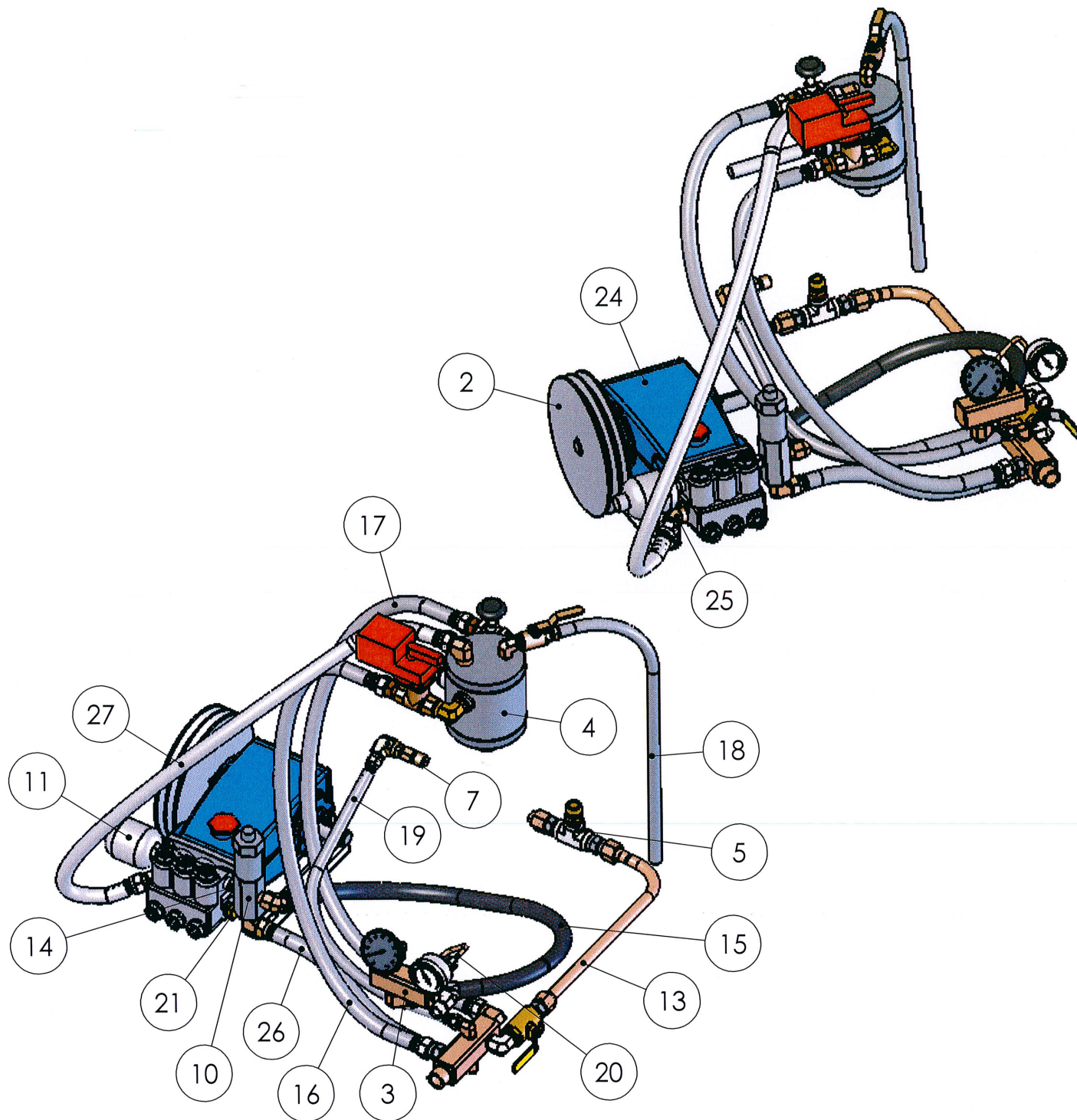

ITEM NO.	PART NUMBER	DESCRIPTION	Pump Assembly / QTY.
1	02722	Cat 1050 15 Frame Plunger Pump	
2	02828	PULLEY SPB - 250 x 2 GROOVE, TL 2517-30	1
3	05960	Hot Water Supply Manifold Assembly	1
4	06040	Level Switch Pot Assembly	1
5	06038	Tank Bottom Manifold Assembly	1
6	05959	Dump Manifold Assembly	1
7	06037	Tank Relief Assembly	1
8	PSBV63BB02QJ3A	GAUGE, PRESSURE, 63mm., BACK ENTRY, 0-100bar., GL.	1
9	4-4 GTX (FJ 228)	FEMALE CONNECTOR FOR TUBE 1/4 TO 1/4NPT BRASS	1
10	06036	Pump Relief To Dump Assembly	1
11	02724	ACCUMULATOR, CAT 6031	1
12	30682-12-12B	FEMALE JIC 37° 3/4" x 3/4"	-
13	06043	Tank Drain To Dump Pipe	1
14	1-2 FFB	PIPE NIPPLE 1/2" NPT BRASS	1
15	06035	HP Hose Assembly	1
16	HOSE 4 (801-12)	3/4" HYDRAULIC HOSE, PUSH-LOK, PARKER, 801-12	1
17	HOSE 6 (801-12)	3/4" HYDRAULIC HOSE, PUSH-LOK, PARKER, 801-12	1
18	HOSE 9 (801-8)	1/2" HYDRAULIC HOSE, PUSH-LOK, PARKER, 801-8	1
19	HOSE 10 (801-8)	1/2" HYDRAULIC HOSE, PUSH-LOK, PARKER, 801-8	1
20	06049	Gauge To Hot Water Supply Manifold Pipe	1
21	3-4HPB	PLUG, HEX. HEAD, 3/4" NPT	1
22	4 BTX (05054)	NUT, 1/4", BRASS	1
23	4 TX (06055)	SLEEVE, 1/4", BRASS	1
25	12 VTX-B (FJ602)	3/4 45 DEG. ELBOW	1
26	HOSE 3 (801-12)	3/4" HYDRAULIC HOSE, PUSH-LOK, PARKER, 801-12	1
27	HOSE 8 (801-12)	3/4" HYDRAULIC HOSE, PUSH-LOK, PARKER, 801-12	1

RELEASED FOR MANUFACTURE
 DATE: 01/06/10 SIGN: [Signature]

THIRD ANGLE PROJECTION 		MATERIAL: SEE BOM				FINISH:		MASS: (kg) 263.44		COPYRIGHT EXISTS IN THIS DRAWING AND ALL INFORMATION THEREIN IN TERMS OF COPYRIGHT LAW. THIS DRAWING IS ONLY TO BE USED FOR THE PURPOSE FOR WHICH IT WAS SUPPLIED TO THE SECOND PARTY AND MAY NOT BE REPRODUCED IN WHOLE OR IN PART BY ANY MEANS WHATSOEVER AND ITS CONTENTS MAY NOT BE DISCLOSED TO ANY OTHER PARTY WITHOUT THE CONSENT OF DIVEX OCEANICS (PTY) LTD. NO LICENCE OR RIGHTS TO MANUFACTURE THE EQUIPMENT IS GIVEN OR IMPLIED.		 DIVEX OCEANICS (PTY) LTD 11 DAWN ROAD MONTAGUE GARDENS CAPE TOWN, 7441 SOUTH AFRICA.		TEL : +27 (0)21 551-2233 FAX : +27 (0)21 551-2275 email : info@divexoceanics.com www.divexoceanics.com		A3
		SCALE		PRODUCT/PROJECT		TITLE										
		1:10		MHE-02		MHE-02 (Mini Heater Electric) General Assembly										
		ALL DIMENSIONS IN MM (UOS) DO NOT SCALE				PART No.		06008		REV R02						
		ALL DIMENSIONS BEFORE PLATING (UOS)				CAD REF/DRG No.		06008		SHT 2 OF 3						
		REMOVE SHARP EDGES & BURRS														
REV	DESCRIPTION OF REVISION	ECN	DRAWN	DATE	DRAFTING CHECK BY	DATE	ENGINEER CHECK BY	DATE	APPROVAL BY	DATE						
R02	CHANGED MOTOR TO 4 POLE	CT00276	R.H.	27/05/10	R.C.	27/05/10	N.M.	27/05/10	N.M.	27/05/10						
R01	AS BUILT		R.H.	15/10/09	R.C.	17/10/09	N.M.	17/10/09	N.M.	17/10/09						
R00	FIRST ISSUE	---	R.H.	03/08/09	R.C.	27/08/09	N.M.	27/08/09	N.M.	27/08/09						

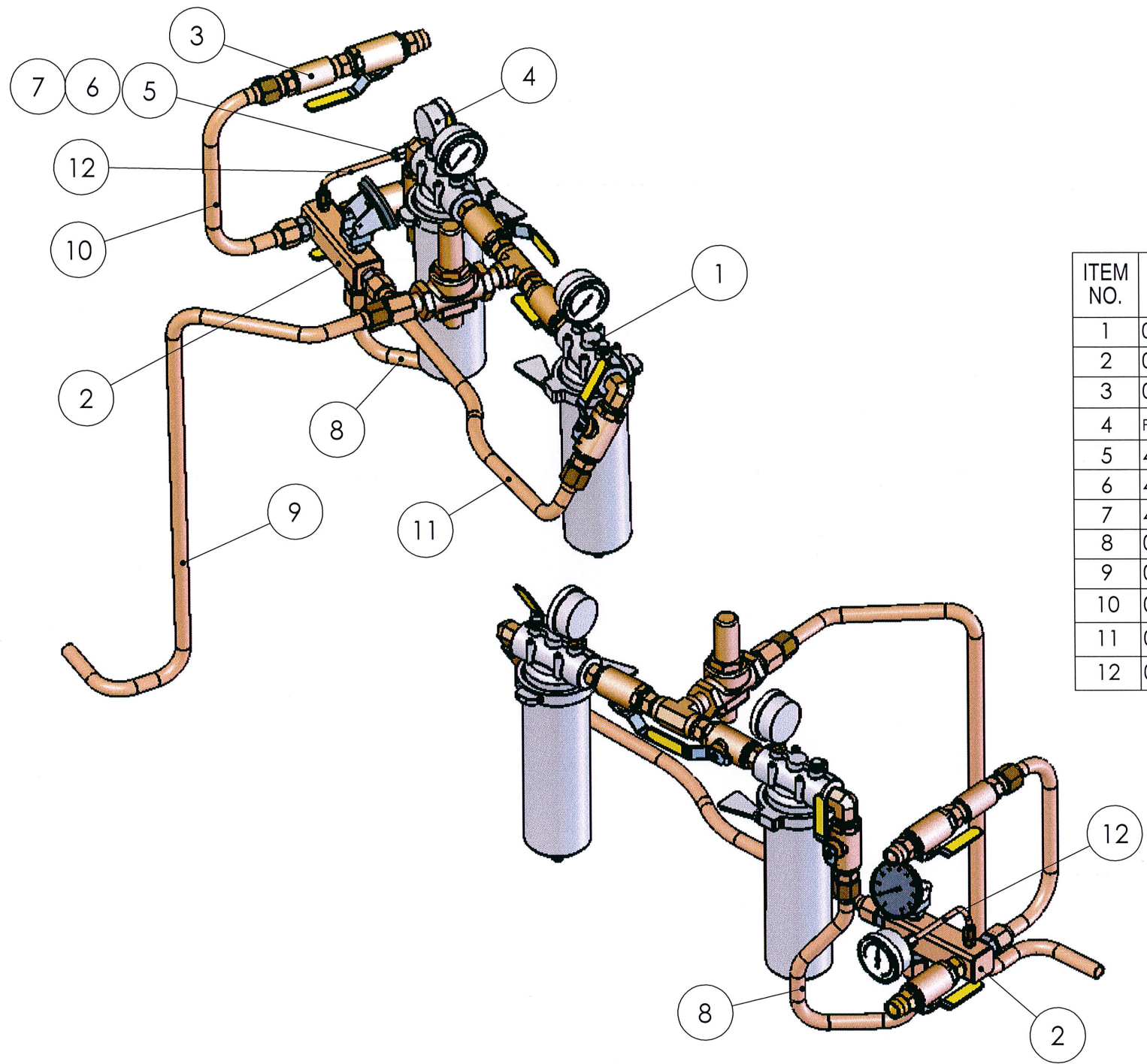

ITEM NO.	PART NUMBER	DESCRIPTION	Sea Water In Piping Assembly/QTY.
1	06019	Filter Assembly	1
2	05958	Sea Water In Manifold Assembly	1
3	06042	Fresh Water For Rinse Assembly	1
4	PBBV63BB02QJ2A	PRESSURE GAUGE, 63mm. BACK ENTRY, 0-10 bar.	1
5	4 GTX-B	1/4" FEMALE CONNECTOR, BRASS	1
6	4 BTX-B	1/4" HEX. NUT, BRASS	1
7	4 TX-B	1/4" TUBE SLEEVE, BRASS	1
8	06045	Sea Water In To Filter Assembly Pipe	1
9	06047	Filter To Tank Supply Pipe	1
10	06044	Fresh Water Rinse / Sea Water In Pipe	1
11	06046	Filter To Supply Pipe	1
12	06048	Gauge To Sea Water In Pipe	1

RELEASED FOR MANUFACTURE
 DATE: 01/06/10 SIGN: *[Signature]*

THIRD ANGLE PROJECTION 		MATERIAL: SEE BOM		FINISH:		MASS: (kg) 263.44		COPYRIGHT EXISTS IN THIS DRAWING AND ALL INFORMATION THEREIN IN TERMS OF COPYRIGHT LAW. THIS DRAWING IS ONLY TO BE USED FOR THE PURPOSE FOR WHICH IT WAS SUPPLIED TO THE SECOND PARTY AND MAY NOT BE REPRODUCED IN WHOLE OR IN PART BY ANY MEANS WHATSOEVER AND ITS CONTENTS MAY NOT BE DISCLOSED TO ANY OTHER PARTY WITHOUT THE CONSENT OF DIVEX OCEANICS (PTY) LTD. NO LICENCE OR RIGHTS TO MANUFACTURE THE EQUIPMENT IS GIVEN OR IMPLIED.				DIVEX OCEANICS (PTY) LTD 11 DAWN ROAD MONTAGUE GARDENS CAPE TOWN, 7441 SOUTH AFRICA.		TEL : +27 (0)21 551-2233 FAX : +27 (0)21 551-2275 email : info@divexoceanics.com www.divexoceanics.com		A3	
										OVER-TO ± ± ± 0-6 0.1 0.2 0.5 6-30 0.2 0.5 1.0 30-100 0.3 0.8 1.5 100-300 0.5 1.2 2.0 300-1000 0.8 2.0 3.0 1000-3000 1.2 3.0 5.0 3000-PLUS 2.0 4.0 8.0 ANGLE 0.25° 0.5° 1°		SCALE 1:7.5		PRODUCT/PROJECT MHE-02		TITLE MHE-02 (Mini Heater Electric) General Assembly	
R02 CHANGED MOTOR TO 4 POLE CT00276 R.H. 27/05/10 R.C. 27/05/10 N.M. 27/05/10 N.M. 27/05/10		R01 AS BUILT --- R.H. 15/10/09 R.C. 17/10/09 N.M. 17/10/09 N.M. 17/10/09		R00 FIRST ISSUE --- R.H. 03/08/09 R.C. 27/08/09 N.M. 27/08/09 N.M. 27/08/09						ALL DIMENSIONS IN MM (UOS) DO NOT SCALE		PART No. 06008 REV R02					
REV DESCRIPTION OF REVISION ECN DRAWN DATE DRAFTING CHECK BY DATE ENGINEER CHECK BY DATE APPROVAL BY DATE										ALL DIMENSIONS BEFORE PLATING (UOS)		CAD REF/DRG No. 06008 SHT 3 OF 3					
										REMOVE SHARP EDGES & BURRS							