

GR29 UNDERWATER GRINDER

STANLEY®



The Stanley Hydraulic **GR29** Grinder is a right angle grinder ("vertical grinder") that can be used for grinding and cleaning in underwater applications with a variety of wheels, brushes and attachments. The high torque gear motor drives a standard $\frac{5}{8}$ " - 11 threaded spindle. A 9" adjustable wheel guard, two position assist handle and trigger guard are standard. Painted hi-visibility yellow.

SPECIFICATIONS

Capacity	9" / 23 cm Wheel
Spindle	$\frac{5}{8}$ " - 11 Threaded
Circuit Type	Open Center
Flow Range	4-12 gpm / 15-45 lpm
Working Pressure	1000-2500 psi / 70-175 bar
Full Relief Setting	2250 psi / 155 bar
RPM	3200 @ 12 gpm / 45 lpm
Weight (with guard)	15 lbs / 6.8 kg
Length	11" / 28 cm
Width (with guard)	10 $\frac{1}{4}$ " / 26 cm
Hydraulic Ports	-8 SAE O-ring
Connection Size and Type	$\frac{3}{8}$ " Male Pipe Adapter
Couplers	Varies with model (See Ordering Information)
Hose Whips	No (See Accessories)

FEATURES

- Integral Stanley Hyrevz gear motor produces high torque
- Stainless Steel spools and fasteners
- Two position assist handle for right/left hand operation
- Oversized trigger with guard for diver comfort
- Adjustable wheel guard for infinite positions
- Plastisol covered handle for comfortable ergonomic grip
- Use with grinding wheels, hull scrubbing brushes, wire and nylon brushes, barnacle busters and Desmond wheels
- 3200 rpm @ 12 gpm
- Cast-in lifting eye

GR29 UNDERWATER GRINDER

STANLEY

ORDERING INFORMATION

PART NUMBER

GR29310 Grinder, Underwater, less couplers

GR2930101 Grinder, Underwater, couplers, CE

ACCESSORIES

03971 Flush-Face Coupling Set, $\frac{3}{8}$ " NPT

03974 Flush-Face Coupling Set, $\frac{1}{2}$ " NPT

06830 Hose Whip 18" long, -8 SAE x $\frac{1}{2}$ " NPT

02587 Grinding wheel for metal, 9" diameter x $\frac{5}{8}$ - 11 thd

02588 Grinding wheel for masonry, 9" diameter x $\frac{5}{8}$ - 11 thd

03691 Grinding wheel, 7" diameter x $\frac{5}{8}$ - 11 thread

05194 Adapter, $\frac{5}{8}$ - 11 thread, depressed center wheel

31848 Dual Hose, 50' x $\frac{1}{2}$ ", with couplers

31972 Dual Hose, 25' x $\frac{1}{2}$ ", with couplers

58633 Twinned Hose, 25' x $\frac{1}{2}$ ", with couplers

58634 Twinned Hose, 50' x $\frac{1}{2}$ ", with couplers

When hydraulic hose exceeds 100' (30.4 m) in length, increase I.D. of both pressure and return hose. For more information, consult Stanley Hydraulic Tools.

IMPORTANT

To fill out a Product Warranty Recording form and for information on your warranty visit stanleyhydraulic.com and select the Warranty tab.

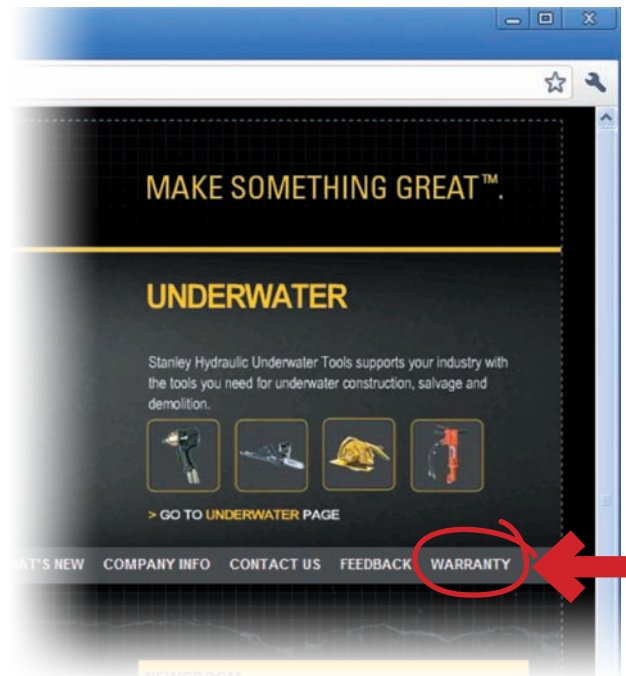

Note: The warranty recording form must be submitted to validate the warranty.

All Stanley Hydraulic Tools, parts, accessories and allied equipment are subject to design improvements, specifications and price changes at any time without notice and with no obligation to units already sold. Weights, dimensions and operating specifications listed herein are subject to change without notice. Where specifications are critical to your applications, please consult Stanley Hydraulic Tools.